



## LCH 型荷重元 Load cell

LCH荷重元係專為值壓量測而設計之荷重元，採用圓柱形直壓式結構，體積小，剛性強，結構穩固，一體成形設計，簡潔美觀堅固耐用，非常適合用於壓入式力量量測，具以下特點：

LCH load cell is a special design for press - in or press - out force measurement. Consisted of spherical construction. so it is small and rigid. In addition contained one - part simple design. pretty shape strong and durable. Good ideal for using in compressed force control.

### ● 特點 Features

純壓式 Only compression

體積小 Small size

LCH - 2, 3.5, 5, 10, 20, 30 kN

50, 100, 200, 300, 500 kN

安裝容易 Easy installation

高剛性 Rigid



### ● 安裝尺寸 Installation Dimensions

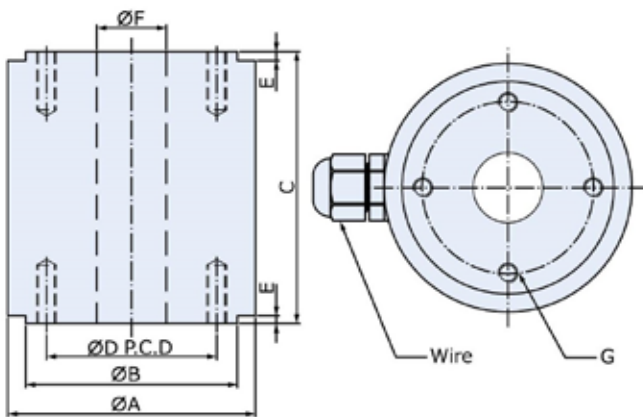

TYPE	A	B	C	D	E	F	G
LCH - 2 kN (203.9 kgf)	43	35	50	24	1	10	(8)M4 x 0.7 x 8 deep
LCH - 3.5 kN (356.9 kgf)							
LCH - 5 kN (509.9 kgf)							
LCH - 10 kN (1.020 tf)	64	54.7	70	44	2	18	(8)M5 x 0.8 x 8 deep
LCH - 20 kN (2.039 tf)							
LCH - 30 kN (3.059 tf)							
LCH - 50 kN (5.099 tf)	64	54.7	80	44	2	18	(8)M5 x 0.8 x 8 deep
LCH - 100 kN (10.20 tf)							
LCH - 200 kN (20.39 tf)							
LCH - 300 kN (30.59 tf)	100	88	120	70	4	20	(8)M8 x 1.25 x 15 deep
LCH - 500 kN (50.99 tf)	132	118	150	90	4	30	(8)M10 x 1.5 x 18 deep

### ● 規格 Specification

額定輸出 Rated Output	1.0mV / V
總和誤差 Total Error	±0.5%R.O.
重現性 Repeatability	±0.2%R.O.
潛變 Creep	0.05% / 20min
輸入阻抗 Input Resistance	800 ± 50 Ω
輸出阻抗 Output Resistance	700 ± 10 Ω
最大輸入電源 Max. Excitation Voltage	20V
建議輸入電源 Recommended Excitation Voltage	10V
溫度補償範圍 Compensated Temp. Range	-10°C ~ 50°C
使用範圍 Safe Temp. Range	-20°C ~ 70°C
溫度對零點之影響 Temp. Effect on Zero Balance	0.05%R.O. / 10°C
溫度對額定輸出之影響 Temp. Effect on Rated Output	0.03% Load / 10°C
零點誤差 Zero Balance	±3%R.O.
容許負荷 Safe Over Load Rating	150%
導線長度 Cable Length	3m
接線方式 Cable Connection	Input : Red (+) Exci : Black (-) Exci Output : Green (+) Sign White (-) Sign