



LRM 型荷重元 Load cell

LRM型荷重元施力點與固定點在同一軸線上，並採用圓柱型結構，安裝容易且非常穩固，本型荷重元並以外殼保護感應部份，非常精確，堅固耐用，適用於吊秤及各式重量及力量量測上，具有以下特點。

This LRM type load cell let force and fixed point at the same axis. Moreover, it constructed of spherical structure, it is very stable and easy to install. An outer shell protects the sensing element. Very high precession, rigid and durable.

● 特點 Features

拉壓兩用 Tension and compression 高精密 High accuracy
結構穩固 Stable and rigid 安裝容易 Easy installation
LRM - 20, 50, 100, 200, 350, 500 N
1, 2, 3.5, 5, 10, 20, 30, 50, 100 kN



● 安裝尺寸 Installation Dimensions

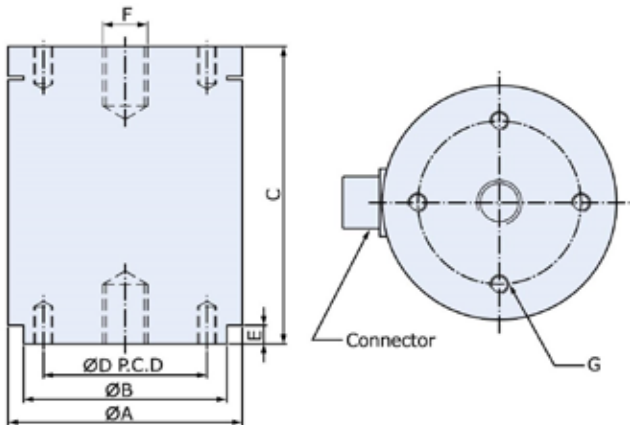

TYPE	A	B	C	D	E	F	G
LRM-20 N (2.039 kgf)	63	54.7	60	44	2	(2)M8x1.25x12deep	(8)M4x 0.7 x 8deep
LRM-50 N (5.099 kgf)							
LRM-100 N (10.20 kgf)							
LRM-200 N (20.39 kgf)							
LRM-350 N (35.69 kgf)							
LRM-500 N (50.99 kgf)							
LRM-1 kN (102.0 kgf)	63	54.7	80	44	5	(2)M12x1.75x16deep	(8)M5x 0.8 x 8deep
LRM-2 kN (203.9 kgf)							
LRM-3.5 kN (356.9 kgf)							
LRM-5 kN (509.9 kgf)							
LRM-10 kN (1.020 tf)	83	73	100	50	2	(2)M16x2.0x20deep	(8)M10x 1.5 x 15deep
LRM-20 kN (2.039 tf)							
LRM-30 kN (3.059 tf)	88	78	120	55	4	(2)M20x2.0x25deep	(8)M12x 1.75 x 18deep
LRM-50 kN (5.099 tf)	115	105	180	70	10	(2)M30x2.0x40deep	(8)M12x 1.75 x 18deep
LRM-100 kN (10.20 tf)							

● 規格 Specification

額定輸出 Rated Output	2.0mV / V (LRM 20 ~ 50 N : 1.0m V / V)
總和誤差 Total Error	±0.05%R.O.
重現性 Repeatability	±0.03%R.O.
潛變 Creep	0.05% / 20min
輸入阻抗 Input Resistance	430 or 405 ± 25 Ω
輸出阻抗 Output Resistance	350 Ω
最大輸入電源 Max. Excitation Voltage	20V
建議輸入電源 Recommended Excitation Voltage	10V
溫度補償範圍 Compensated Temp. Range	-10°C ~ 50°C
使用範圍 Safe Temp. Range	-20°C ~70°C
溫度對零點之影響 Temp. Effect on Zero Balance	0.05%R.O. / 10°C
溫度對額定輸出之影響 Temp. Effect on Rated Output	0.03% Load / 10°C
零點誤差 Zero Balance	±3%R.O.
容許負荷 Safe Over Load Rating	150%
導線長度 Cable Length	3m
接線方式 Cable Connection	Input : Red (+) Exci : Black (-) Exci Output : Green (+) Sign White (-) Sign