



得豐實業有限公司

Dfwisdom Industrial CO., LTD

ML 型荷重元 Load cell

ML荷重元係高精度力量感測器，使用應變規元件，變形量小，精度高，所有感測電路均藏於金屬彈性體內，完全密封保護，不受外界干擾，穩定性高，具以下特點：

ML load cell is precision, small and compact. The sensing element imbedded in the metal structure, and hermetically sealed. It is ideally use to force control machine, scales and general weight measurement.



● 特點 Features

高精度 High accuracy

剛性強 Rigid

輕薄設計 Light and thin design

ML - 25, 50, 100, 250, 500 N

1, 2.5, 5, 10, 20, 30, 50 kN

溫度補償 Thermally compensated

整體密封保護 Hermetically Sealed

● 安裝尺寸 Installation Dimensions

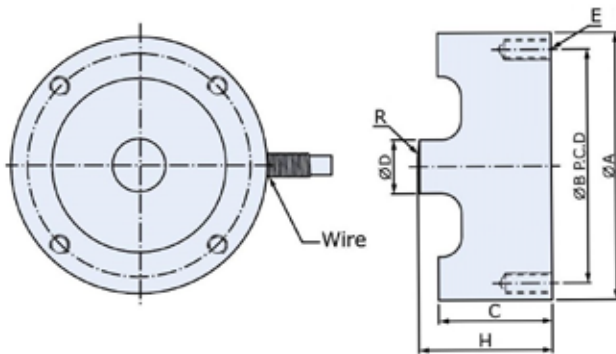

TYPE	A	B	C	H	D	R	E
ML - 25 N (2.549 kgf)	35	31	15	18	5	20	(4)M2.5 x 0.45 x 7 deep
ML - 50 N (5.099 kgf)							
ML - 100 N (10.20 kgf)							
ML - 250 N (25.49 kgf)							
ML - 500 N (50.99 kgf)	40	35	17	20	8	30	(4)M3 x 0.5 x 7 deep
ML - 1 kN (102.0 kgf)							
ML - 2.5 kN (254.9 kgf)							
ML - 5 kN (509.9 kgf)	50	44	22	25	12	40	(4)M4 x 0.7 x 10 deep
ML - 10 kN (1.020 tf)							
ML - 20 kN (2.039 tf)							
ML - 30 kN (3.059 tf)							
ML - 50 kN (5.099 tf)	50	44	22	25	15	40	(4)M4 x 0.7 x 10 deep

● 規格 Specification

額定輸出 Rated Output	1.5mV / V
總和誤差 Total Error	±0.1%R.O.
重現性 Repeatability	±0.05%R.O.
潛變 Creep	0.1% / 20min
輸入阻抗 Input Resistance	430 or 405 ± 25 Ω
輸出阻抗 Output Resistance	350 ± 5 Ω
最大輸入電源 Max. Excitation Voltage	10V
建議輸入電源 Recommended Excitation Voltage	3 - 8V
溫度補償範圍 Compensated Temp. Range	-10°C ~ 50°C
使用範圍 Safe Temp. Range	-20°C ~ 70°C
溫度對零點之影響 Temp. Effect on Zero Balance	0.05%R.O. / 10°C
溫度對額定輸出之影響 Temp. Effect on Rated Output	0.03% Load / 10°C
零點誤差 Zero Balance	±3%R.O.
容許負荷 Safe Over Load Rating	150%
導線長度 Cable Length	3m
接線方式 Cable Connection	Input : Red (+) Exci : Black (-) Exci Output : Green (+) Sign White (-) Sign