



# 得豐實業有限公司

Dfwisdom Industrial CO., LTD

## RT 迴轉式扭力計 Rotary torque sensor

RT迴轉式扭力計，係專為旋轉中量測扭力而設計之感測器，採用剪力式轉軸應力量測結構，剛性強，結構穩固，轉速高，採用碳式傳遞量測訊號，雜訊低，重量輕，一體式設計，簡潔美觀及堅固耐用具，以下之特點：

RT Rotary Torque sensor is a special design for measuring the torque on a continual rotation shaft. It constructs of a rigid spindle with shear strain detect sensor. The high-speed carbon brush picks up torque signal. Yet, that is low noise small, light and precise.



### ● 特點 Features

體積小 Small                      高轉速 High Speed                      剛性強 Rigid  
 低雜訊 Low Noise                      碳刷式可旋轉量測 Carbon brush type rotating measurement  
 RT - 0.25, 0.5, 1, 2.5, 5, 10, 25, 50, 100, 250, 500, 1k, 2k, 2.5k, 5k, 10k Nm

### ● 安裝尺寸 Installation Dimensions

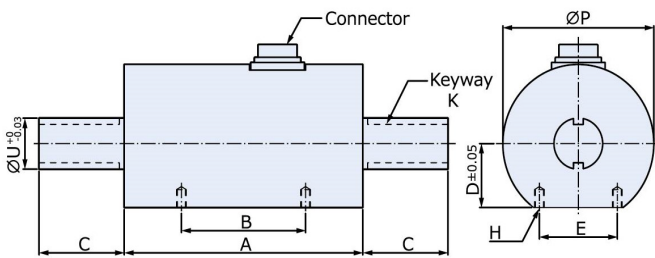

TYPE	A	B	C	D	E	H	K	P	U	容許轉速
RT - 0.25 Nm										
RT - 0.5 Nm										
RT - 1 Nm	96	51	20	18	32	M4x0.7 x7deep	3x1.8	52	10	200 RPM
RT - 2.5 Nm										
RT - 5 Nm										
RT - 10 Nm										
RT - 25 Nm	98	51	35	25	32	M4x0.7 x7deep	4x2.5	62	20	200 RPM
RT - 50 Nm										
RT - 100 Nm										
RT - 250 Nm										
RT - 500 Nm	115	65	60	36	44	M6x1.0 x8deep	10x5	88	40	100 RPM
RT - 1k Nm										
RT - 2k Nm										
RT - 2.5k Nm	120	65	85	48	50	M6x1.0 x8deep	12x5	113	55	100 RPM
RT - 5k Nm	131	65	98.5	49	50	M6x1.0 x8deep	16x6	114	65	100 RPM
RT - 10k Nm	131	75	135	61	60	M6x1.0 x8deep	25x9	140	90	100 RPM

### ● 規格 Specification

額定輸出 Rated Output	1.0mV / V
總和誤差 Total Error	±0.3%R.O.
重現性 Repeatability	±0.2%R.O.
潛變 Creep	0.1% / 20min
輸入阻抗 Input Resistance	430 or 385 or 350 Ω
輸出阻抗 Output Resistance	350 ± 5Ω
最大輸入電源 Max. Excitation Voltage	20V
建議輸入電源 Recommended Excitation Voltage	10V
使用範圍 Safe Temp. Range	-10°C ~ 50°C
溫度對零點之影響 Temp. Effect on Zero Balance	0.05%R.O. / 10°C
溫度對額定輸出之影響 Temp. Effect on Rated Output	0.03% Load / 10°C
零點誤差 Zero Balance	±3%R.O.
容許負荷 Safe Over Load Rating	150%
導線長度 Cable Length	3m
接線方式 Cable Connection	Input : Red ( + ) Exci : Black ( - ) Exci Output : Green ( + ) Sign White ( - ) Sign